

●SW1/4

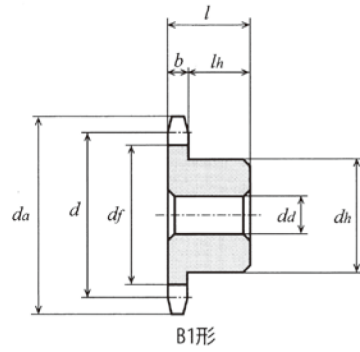
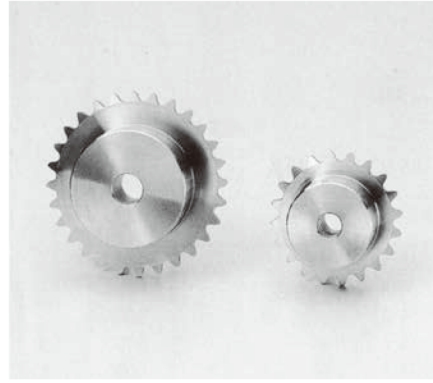

●ピッチ6.35 ポリアセタール

品番	価格	歯数 z	ピッチ円直径 ϕ_{da}	外径 ϕ_{da}	歯底円直径 ϕ_{df}	形	歯幅 b	穴径 ϕ_{dd}	ハブ外径 ϕ_{dh}	ハブ長さ l_h	全長 l
SW1/4D 8-B	360	8	16.6	19.1	13.3	B1	2.8	6	10	10	12.8
SW1/4D 9-B	360	9	18.6	21.3	15.3	B1	2.8	6	10	10	12.8
SW1/4D 10-B	360	10	20.5	23.4	17.2	B1	2.8	8	14	10	12.8
SW1/4D 11-B	370	11	22.5	25.4	19.2	B1	2.8	8	16	10	12.8
SW1/4D 12-B	390	12	24.5	27.5	21.2	B1	2.8	8	18	10	12.8
SW1/4D 13-B	410	13	26.5	29.6	23.2	B1	2.8	8	20	10	12.8
SW1/4D 14-B	450	14	28.5	31.6	25.2	B1	2.8	8	22	10	12.8
SW1/4D 15-B	480	15	30.5	33.7	27.2	B1	2.8	8	22	10	12.8
SW1/4D 16-B	510	16	32.5	35.7	29.2	B1	2.8	8	26	12	14.8
SW1/4D 17-B	580	17	34.6	37.8	31.3	B1	2.8	8	26	12	14.8
SW1/4D 18-B	630	18	36.6	39.8	33.3	B1	2.8	8	28	12	14.8
SW1/4D 19-B	700	19	38.6	41.9	35.3	B1	2.8	8	28	12	14.8
SW1/4D 20-B	770	20	40.6	43.9	37.3	B1	2.8	8	28	15	17.8
SW1/4D 21-B	820	21	42.6	45.9	39.3	B1	2.8	8	35	15	17.8
SW1/4D 22-B	900	22	44.6	48	41.3	B1	2.8	8	35	15	17.8
SW1/4D 23-B	980	23	46.6	50	43.3	B1	2.8	8	35	15	17.8
SW1/4D 24-B	1,070	24	48.6	52	45.3	B1	2.8	8	35	15	17.8
SW1/4D 25-B	1,220	25	50.7	54.1	47.3	B1	2.8	8	35	15	17.8
SW1/4D 26-B	1,280	26	52.7	56.1	49.4	B1	2.8	10	35	15.2	18
SW1/4D 28-B	1,400	28	56.7	60.2	53.4	B1	2.8	10	38	15.2	18
SW1/4D 30-B	1,530	30	60.7	64.2	57.4	B1	2.8	10	38	15.2	18
SW1/4D 32-B	1,640	32	64.8	68.3	61.5	B1	2.8	12	42	15.2	18

●ピッチ6.35 S45C

品番	価格	歯数 z	ピッチ円直径 ϕ_{da}	外径 ϕ_{da}	歯底円直径 ϕ_{df}	形	歯幅 b	穴径 $d_d(H9)$ ϕ	ハブ外径 ϕ_{dh}	ハブ長さ l_h	全長 l
SW1/4S 8-B	580	8	16.6	19.1	13.3	B1	2.8	6	10	10	12.8
SW1/4S 9-B	600	9	18.6	21.3	15.3	B1	2.8	6	10	10	12.8
SW1/4S 10-B	620	10	20.5	23.4	17.2	B1	2.8	8	14	10	12.8
SW1/4S 11-B	660	11	22.5	25.4	19.2	B1	2.8	8	16	10	12.8
SW1/4S 12-B	680	12	24.5	27.5	21.2	B1	2.8	8	18	10	12.8
SW1/4S 13-B	710	13	26.5	29.6	23.2	B1	2.8	8	20	10	12.8
SW1/4S 14-B	740	14	28.5	31.6	25.2	B1	2.8	8	22	10	12.8
SW1/4S 15-B	810	15	30.5	33.7	27.2	B1	2.8	8	22	10	12.8
SW1/4S 16-B	860	16	32.5	35.7	29.2	B1	2.8	8	26	12	14.8
SW1/4S 17-B	880	17	34.6	37.8	31.3	B1	2.8	8	26	12	14.8
SW1/4S 18-B	910	18	36.6	39.8	33.3	B1	2.8	8	28	12	14.8
SW1/4S 19-B	950	19	38.6	41.9	35.3	B1	2.8	8	28	12	14.8
SW1/4S 20-B	1,000	20	40.6	43.9	37.3	B1	2.8	8	28	15	17.8
SW1/4S 21-B	1,060	21	42.6	45.9	39.3	B1	2.8	8	35	15	17.8
SW1/4S 22-B	1,110	22	44.6	48	41.3	B1	2.8	8	35	15	17.8
SW1/4S 23-B	1,150	23	46.6	50	43.3	B1	2.8	8	35	15	17.8
SW1/4S 24-B	1,220	24	48.6	52	45.3	B1	2.8	8	35	15	17.8
SW1/4S 25-B	1,390	25	50.7	54.1	47.3	B1	2.8	8	35	15	17.8
SW1/4S 26-B	1,450	26	52.7	56.1	49.4	B1	2.8	10	35	15.2	18
SW1/4S 28-B	1,600	28	56.7	60.2	53.4	B1	2.8	10	38	15.2	18
SW1/4S 30-B	1,750	30	60.7	64.2	57.4	B1	2.8	10	38	15.2	18
SW1/4S 32-B	1,910	32	64.8	68.3	61.5	B1	2.8	12	42	15.2	18

●KSSB



○セットスクリューと両丸キー（キー寸法入り製品のみ）は製品に付属しています。

◆品番表示

KSSB 10 22-10

MP 10:MP1.0 15:MP1.5 20:MP2.0
歯数 穴径 (JIS H7級)

○タップ位置はキー溝の上部且つボス長さ中央部です。

●MP=1.0

歯幅: 10

KSSB	価格	穴径	キー幅	キー深	タップ
1022-10	760	10	—	—	M4
1024-10	760	10	—	—	M4
1025-10	780	10	—	—	M4
1026-10	810	10	—	—	M4
1028-10	860	10	—	—	M4
1028-12	980	12	4	1.8	M4
1030-10	910	10	—	—	M4
1030-12	1,010	12	4	1.8	M4
1032-10	960	10	—	—	M4
1032-12	1,070	12	4	1.8	M4
1036-12	1,190	12	4	1.8	M4
1036-15	1,210	15	5	2.3	M4
1040-12	1,010	12	4	1.8	M4
1040-15	1,060	15	5	2.3	M4
1042-12	1,060	12	4	1.8	M4
1042-15	1,080	15	5	2.3	M4
1045-12	1,110	12	4	1.8	M4
1045-15	1,130	15	5	2.3	M4
1048-12	1,220	12	4	1.8	M4
1048-15	1,240	15	5	2.3	M4
1050-12	1,240	12	4	1.8	M4
1050-15	1,280	15	5	2.3	M4
1050-18	1,330	18	6	2.8	M5
1060-12	1,490	12	4	1.8	M4
1060-15	1,520	15	5	2.3	M4
1060-18	1,570	18	6	2.8	M5
1064-12	1,600	12	4	1.8	M4
1064-15	1,620	15	5	2.3	M4
1064-18	1,670	18	6	2.8	M5
1070-12	1,760	12	4	1.8	M4
1070-15	1,800	15	5	2.3	M4
1070-18	1,850	18	6	2.8	M5
1072-12	1,900	12	4	1.8	M4
1072-15	1,930	15	5	2.3	M4
1072-18	1,950	18	6	2.8	M5
1080-15	2,080	15	5	2.3	M4
1080-18	2,100	18	6	2.8	M5
1080-20	2,170	20	6	2.8	M5

●MP=1.5

歯幅: 15

KSSB	価格	穴径	キー幅	キー深	タップ
1518-10	920	10	—	—	M4
1520-12	1,140	12	4	1.8	M4
1522-12	1,140	12	4	1.8	M4
1524-12	1,140	12	4	1.8	M4
1524-15	1,140	15	5	2.3	M4
1525-12	1,180	12	4	1.8	M4
1525-15	1,210	15	5	2.3	M4
1526-12	1,200	12	4	1.8	M4
1526-15	1,240	15	5	2.3	M4
1528-15	1,310	15	5	2.3	M4
1528-18	1,340	18	6	2.8	M5
1530-15	1,360	15	5	2.3	M4
1530-18	1,430	18	6	2.8	M5
1532-15	1,440	15	5	2.3	M4
1532-18	1,500	18	6	2.8	M5
1536-18	1,670	18	6	2.8	M5
1536-20	1,760	20	6	2.8	M5
1540-18	1,830	18	6	2.8	M5
1540-20	1,900	20	6	2.8	M5
1540-25	1,950	25	8	3.3	M6
1542-18	1,930	18	6	2.8	M5
1542-20	2,010	20	6	2.8	M5
1542-25	2,070	25	8	3.3	M6
1545-18	2,100	18	6	2.8	M5
1545-20	2,180	20	6	2.8	M5
1545-25	2,220	25	8	3.3	M6
1548-18	2,220	18	6	2.8	M5
1548-20	2,290	20	6	2.8	M5
1548-25	2,370	25	8	3.3	M6
1550-18	2,220	18	6	2.8	M5
1550-20	2,310	20	6	2.8	M5
1550-25	2,370	25	8	3.3	M6
1560-18	2,770	18	6	2.8	M5
1560-20	2,830	20	6	2.8	M5
1560-25	2,880	25	8	3.3	M6
1564-18	3,250	18	6	2.8	M5
1564-20	3,310	20	6	2.8	M5
1564-25	3,310	25	8	3.3	M6
1570-18	3,710	18	6	2.8	M5
1570-20	3,770	20	6	2.8	M5
1570-25	3,760	25	8	3.3	M6
1572-18	4,030	18	6	2.8	M5
1572-20	4,080	20	6	2.8	M5
1572-25	4,080	25	8	3.3	M6

●MP=2.0

歯幅: 20

KSSB	価格	穴径	キー幅	キー深	タップ
2015-12	1,100	12	4	1.8	M4
2016-12	1,130	12	4	1.8	M4
2018-15	1,240	15	5	2.3	M4
2020-15	1,350	15	5	2.3	M4
2022-15	1,450	15	5	2.3	M4
2022-18	1,500	18	6	2.8	M5
2024-15	1,600	15	5	2.3	M4
2024-18	1,650	18	6	2.8	M5
2024-20	1,720	20	6	2.8	M5
2025-15	1,660	15	5	2.3	M4
2025-18	1,690	18	6	2.8	M5
2025-20	1,780	20	6	2.8	M5
2026-15	1,660	15	5	2.3	M4
2026-18	1,690	18	6	2.8	M5
2026-20	1,780	20	6	2.8	M5
2028-18	1,860	18	6	2.8	M5
2028-20	1,930	20	6	2.8	M5
2028-25	1,980	25	8	3.3	M6
2030-18	2,010	18	6	2.8	M5
2030-20	2,090	20	6	2.8	M5
2030-25	2,160	25	8	3.3	M6
2032-18	2,070	18	6	2.8	M5
2032-20	2,160	20	6	2.8	M5
2032-25	2,210	25	8	3.3	M6
2036-18	2,290	18	6	2.8	M5
2036-20	2,390	20	6	2.8	M5
2036-25	2,430	25	8	3.3	M6
2040-18	2,700	18	6	2.8	M5
2					

●KSSB



◆品番表示

KSSB 25 15-15

MP 25:MP2.5 30:MP3.0 40:MP4.0
 歯数 穴径 (JIS H7級)

○セットスクリューと両丸キー (キー寸法入り製品のみ) は製品に付属しています。

○タップ位置はキー溝の上部且つボス長さ中央部です。

●MP=2.5

歯幅: 25

KSSB	価格	穴径	キー		タップ
			幅	深	
2515-15	1,460	15	5	2.3	M4
2516-15	1,560	15	5	2.3	M4
2518-15	1,760	15	5	2.3	M4
2518-18	1,830	18	6	2.8	M5
2518-20	1,890	20	6	2.8	M5
2520-15	1,890	15	5	2.3	M4
2520-18	1,940	18	6	2.8	M5
2520-20	2,010	20	6	2.8	M5
2522-18	2,120	18	6	2.8	M5
2522-20	2,180	20	6	2.8	M5
2522-25	2,260	25	8	3.3	M6
2524-18	2,220	18	6	2.8	M5
2524-20	2,290	20	6	2.8	M5
2524-25	2,380	25	8	3.3	M6
2525-18	2,280	18	6	2.8	M5
2525-20	2,370	20	6	2.8	M5
2525-25	2,420	25	8	3.3	M6
2526-18	2,450	18	6	2.8	M5
2526-20	2,530	20	6	2.8	M5
2526-25	2,610	25	8	3.3	M6
2528-18	2,660	18	6	2.8	M5
2528-20	2,730	20	6	2.8	M5
2528-25	2,790	25	8	3.3	M6
2530-20	2,990	20	6	2.8	M5
2530-25	2,990	25	8	3.3	M6
2536-25	3,670	25	8	3.3	M6
2536-30	3,670	30	8	3.3	M6
2540-20	4,330	20	6	2.8	M5
2540-25	4,410	25	8	3.3	M6
2540-30	4,410	30	8	3.3	M6
2542-20	4,930	20	6	2.8	M5
2542-25	4,980	25	8	3.3	M6
2542-30	4,980	30	8	3.3	M6
2545-20	5,350	20	6	2.8	M5
2545-25	5,390	25	8	3.3	M6
2545-30	5,390	30	8	3.3	M6
2548-20	5,690	20	6	2.8	M5
2548-25	5,740	25	8	3.3	M6
2548-30	5,750	30	8	3.3	M6
2550-25	6,460	25	8	3.3	M6
2550-30	6,520	30	8	3.3	M6
2550-35	6,520	35	10	3.3	M8
2560-25	8,170	25	8	3.3	M6
2560-30	8,250	30	8	3.3	M6
2560-35	8,250	35	10	3.3	M8
2564-25	9,210	25	8	3.3	M6
2564-30	9,270	30	8	3.3	M6
2564-35	9,270	35	10	3.3	M8

●MP=3.0

歯幅: 30

KSSB	価格	穴径	キー		タップ
			幅	深	
3012-15	1,560	15	5	2.3	M4
3015-15	1,890	15	5	2.3	M4
3015-18	1,950	18	6	2.8	M5
3015-20	2,040	20	6	2.8	M5
3016-15	1,980	15	5	2.3	M4
3016-18	2,040	18	6	2.8	M5
3016-20	2,130	20	6	2.8	M5
3018-18	2,280	18	6	2.8	M5
3018-20	2,370	20	6	2.8	M5
3018-25	2,430	25	8	3.3	M6
3020-20	2,530	20	6	2.8	M5
3020-25	2,610	25	8	3.3	M6
3020-30	2,610	30	8	3.3	M6
3022-20	2,770	20	6	2.8	M5
3022-25	2,850	25	8	3.3	M6
3022-30	2,850	30	8	3.3	M6
3024-20	2,970	20	6	2.8	M5
3024-25	3,030	25	8	3.3	M6
3024-30	3,030	30	8	3.3	M6
3025-20	3,220	20	6	2.8	M5
3025-25	3,230	25	8	3.3	M6
3025-30	3,230	30	8	3.3	M6
3026-20	3,370	20	6	2.8	M5
3026-25	3,380	25	8	3.3	M6
3026-30	3,380	30	8	3.3	M6
3028-20	3,600	20	6	2.8	M5
3028-25	3,700	25	8	3.3	M6
3028-30	3,700	30	8	3.3	M6
3030-25	3,910	25	8	3.3	M6
3030-30	3,910	30	8	3.3	M6
3030-35	4,140	35	10	3.3	M8
3032-25	4,610	25	8	3.3	M6
3032-30	4,610	30	8	3.3	M6
3032-35	4,790	35	10	3.3	M8
3036-25	5,340	25	8	3.3	M6
3036-30	5,340	30	8	3.3	M6
3036-35	5,500	35	10	3.3	M8
3040-30	6,090	30	8	3.3	M6
3040-35	6,270	35	10	3.3	M8
3040-40	6,380	40	12	3.3	M8
3042-30	6,730	30	8	3.3	M6
3042-35	6,910	35	10	3.3	M8
3042-40	7,020	40	12	3.3	M8
3045-30	7,540	30	8	3.3	M6
3045-35	7,770	35	10	3.3	M8
3045-40	7,850	40	12	3.3	M8
3048-30	8,430	30	8	3.3	M6
3048-35	8,660	35	10	3.3	M8
3048-40	8,730	40	12	3.3	M8
3050-30	8,990	30	8	3.3	M6
3050-35	9,160	35	10	3.3	M8
3050-40	9,280	40	12	3.3	M8
3060-35	12,010	35	10	3.3	M8
3060-40	12,090	40	12	3.3	M8
3060-45	12,500	45	14	3.8	M10

●MP=4.0

歯幅: 40

KSSB	価格	穴径	キー		タップ
			幅	深	
4012-18	2,590	18	6	2.8	M5
4012-20	2,660	20	6	2.8	M5
4015-18	3,010	18	6	2.8	M5
4015-20	3,090	20	6	2.8	M5
4015-25	3,170	25	8	3.3	M6
4016-20	3,340	20	6	2.8	M5
4016-25	3,410	25	8	3.3	M6
4016-30	3,410	30	8	3.3	M6
4018-20	3,960	20	6	2.8	M5
4018-25	3,970	25	8	3.3	M6
4018-30	3,970	30	8	3.3	M6
4020-20	4,150	20	6	2.8	M5
4020-25	4,160	25	8	3.3	M6
4020-30	4,160	30	8	3.3	M6
4022-20	4,660	20	6	2.8	M5
4022-25	4,740	25	8	3.3	M6
4022-30	4,740	30	8	3.3	M6
4024-20	5,310	20	6	2.8	M5
4024-25	5,380	25	8	3.3	M6
4024-30	5,380	30	8	3.3	M6
4025-25	5,910	25	8	3.3	M6
4025-30	5,910	30	8	3.3	M6
4025-35	5,910	35	10	3.3	M8
4026-25	6,090	25	8	3.3	M6
4026-30	6,090	30	8	3.3	M6
4026-35	6,280	35	10	3.3	M8
4028-25	6,960	25	8	3.3	M6
4028-30	7,030	30	8	3.3	M6
4028-35	7,030	35	10	3.3	M8
4030-30	7,680	30	8	3.3	M6
4030-35	7,780	35	10	3.3	M8
4030-40	7,870	40	12	3.3	M8
4032-30	8,050	30	8	3.3	M6
4032-35	8,160	35	10	3.3	M8
4032-40	8,250	40	12	3.3	M8
4036-30	10,140	30	8	3.3	M6
4036-35	10,240	35	10	3.3	M8
4036-40	10,330	40	12	3.3	M8
4040-35	12,310	35	10	3.3	M8
4040-40	12,400	40	12	3.3	M8
4040-45	12,790	45	14	3.8	M10
4042-35	12,790	35	10	3.3	M8
4042-40	12,880	40	12	3.3	M8
4042-45	13,280	45	14	3.8	M10
4045-35	15,140	35	10	3.3	M8
4045-40	15,220	40	12	3.3	M8
4045-45	15,620	45	14	3.8	M10
4048-35	17,020	35	10	3.3	M8
4048-40	17,180	40	12	3.3	M8
4048-45	17,730	45	14	3.8	M10
4050-35	18,610	35	10	3.3	M8
4050-40	18,630	40	12	3.3	M8
4050-45	19,240	45	14	3.8	M10

●MPO.75

歯幅7 (歯数12~18は12)

品番	価格		寸法			
	S45C		P.C.D	d _{H7}	B	BL
	SSA	SSB				
0712	410	—	9	—	—	—
0714	420	—	10.5	—	—	—
0715	440	—	11.25	4	—	—
0716	440	—	12	—	—	—
0717	450	—	12.75	—	—	—
0718	460	—	13.5	4	—	—
0719	470	440	14.25	6	12	8
0720	470	440	15	6	12	8
0721	470	460	15.75	6	13	8
0722	470	470	16.5	6	14	8
0723	470	470	17.25	—	14	—
0724	470	480	18	—	15	—
0725	480	490	18.75	6	15	8
0726	480	510	19.5	—	16	—
0727	480	530	20.25	—	17	—
0728	480	530	21	—	18	—
0729	480	570	21.75	—	18	—
0730	480	570	22.5	6	19	8
0732	530	590	24	—	20	—
0734	610	630	25.5	—	20	—
0735	630	630	26.25	—	20	—
0736	650	630	27	—	22	—
0738	660	680	28.5	6	22	8
0740	670	680	30	—	22	—
0742	680	720	31.5	—	22	—
0744	680	750	33	—	22	—
0745	690	750	33.75	—	24	—
0746	740	880	34.5	6	24	8
0748	780	880	36	—	24	—
0750	800	900	37.5	—	26	—
0752	850	900	39	6	—	—
0754	870	900	40.5	6	—	—
0755	870	900	41.25	8	26	8
0756	870	970	42	8	—	—
0758	870	1,000	43.5	8	—	—
0760	900	1,000	45	—	28	—
0762	970	1,210	46.5	—	28	—
0764	1,030	1,210	48	8	28	8
0765	1,060	1,210	48.75	—	30	—
0766	1,080	1,210	49.5	—	30	—
0768	1,110	1,210	51	—	30	—
0770	1,130	1,210	52.5	—	32	—
0772	1,130					

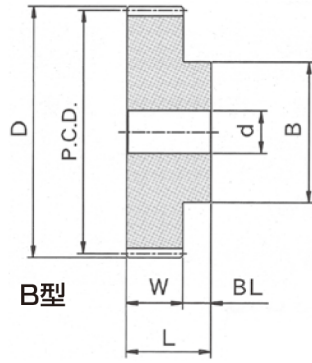
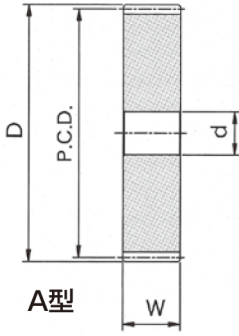

◆品番表示

SS B 20 20

材質 ———— ピッチ ———— 歯数
 SS:S45C 形状
 SN:キャストナイロン A:ベタ
 SU:SUS303 B:片ボス
 SF:FC200

SNA・SNB：キャストナイロン
 SFA：FC200はお問合わせください

●MP1.5

歯幅15 (歯数12は20)

品番	価格				寸法			
	S45C		SUS303		P.C.D.	d _{H7}	B	BL
	SSA	SSB	SUA	SUB				
1512	460	—	1,870	—	18	—	—	—
1513	—	470	—	—	19.5	—	22.5	18
1514	470	470	2,180	1,550	21	8	16	9
1515	470	490	2,180	1,620	22.5	—	18	9
1516	470	520	2,240	1,680	24	—	20	9
1517	470	540	2,240	1,770	25.5	—	20	9
1518	520	630	2,460	2,310	27	—	22	—
1519	520	640	2,460	2,370	28.5	—	22	—
1520	520	650	2,460	2,370	30	10	25	12
1521	610	660	2,460	2,370	31.5	—	25	—
1522	610	720	2,460	2,520	33	—	26	—
1523	610	750	2,460	2,640	34.5	10	27	—
1524	610	750	2,460	2,730	36	12	30	—
1525	630	800	2,730	2,980	37.5	12	30	12
1526	680	840	2,780	3,120	39	12	32	—
1527	690	860	2,950	3,120	40.5	12	32	—
1528	690	870	2,950	3,300	42	14	34	—
1529	750	880	3,220	3,400	43.5	14	35	—
1530	750	950	3,220	3,440	45	14	35	12
1532	850	1,010	3,590	3,870	48	16	35	—
1534	970	1,050	3,980	4,150	51	16	40	—
1535	970	1,120	4,220	4,410	52.5	—	40	—
1536	970	1,130	4,220	4,440	54	—	40	—
1538	1,070	1,240	4,470	4,800	57	16	45	12
1540	1,080	1,280	4,710	5,020	60	—	45	—
1542	1,240	1,410	5,010	5,600	63	—	45	—
1544	1,300	1,520	5,530	5,760	66	—	—	—
1545	1,310	1,530	5,530	6,180	67.5	—	—	—
1546	1,430	1,560	5,840	6,300	69	16	50	12
1548	1,440	1,670	5,840	6,890	72	—	—	—
1550	1,450	1,710	5,970	6,930	75	—	—	—
1552	1,610	1,830	6,410	7,480	78	—	50	—
1554	1,670	1,970	7,490	8,130	81	—	52	—
1555	1,690	1,970	7,490	8,250	82.5	16	52	12
1556	1,830	2,130	—	—	84	—	53	—
1558	1,840	2,130	7,490	8,870	87	—	55	—
1560	1,840	2,170	7,730	9,300	90	—	55	—
1562	2,240	2,340	—	—	93	—	55	—
1564	2,260	2,610	—	—	96	16	60	12
1565	2,280	2,620	—	—	97.5	—	60	—
1566	2,280	2,710	—	—	99	—	60	—
1568	2,310	2,710	—	—	102	—	60	—
1570	2,330	2,720	—	—	105	—	65	—
1572	2,750	2,950	—	—	108	16	65	12
1575	2,760	3,060	—	—	112.5	—	65	—
1576	2,760	3,360	—	—	114	—	65	—
1580	2,760	3,360	—	—	120	—	68	—
1584	3,150	3,730	—	—	126	—	70	—
1585	3,510	3,730	—	—	127.5	16	70	12
1588	3,750	4,180	—	—	132	—	75	—
1590	3,950	4,210	—	—	135	—	75	—
1595	4,280	4,310	—	—	142.5	16	80	—
15100	3,750	4,770	—	—	150	18	85	12
15120	6,180	6,630	—	—	180	18	100	—

●外径はP.C.D+3

●MP2.0

歯幅20

品番	価格				寸法			
	S45C		SUS303		P.C.D.	d _{H7}	B	BL
	SSA	SSB	SUA	SUB				
2012	640	610	2,540	2,490	24	10	18	—
2013	—	670	—	—	26	10	20	—
2014	720	670	2,890	2,490	28	10	21	14
2015	730	730	2,890	2,490	30	10	24	—
2016	760	750	3,090	2,610	32	12	25	—
2017	780	790	3,150	2,860	34	12	27	—
2018	780	850	3,170	2,860	36	—	30	—
2019	780	880	3,210	3,170	38	—	31	—
2020	780	910	3,250	3,260	40	12	33	14
2021	870	990	3,470	3,590	42	—	34	—
2022	920	1,010	3,660	3,650	44	—	36	—
2023	960	1,110	3,860	3,990	46	12	37	—
2024	980	1,130	4,020	4,220	48	14	40	—
2025	1,020	1,160	4,060	4,260	50	14	40	14
2026	1,110	1,240	4,060	5,070	52	14	42	—
2027	1,140	1,250	4,060	5,070	54	14	44	—
2028	1,190	1,360	4,060	5,420	56	16	45	—
2029	1,330	1,390	4,060	5,500	58	16	46	—
2030	1,330	1,520	4,060	5,500	60	18	48	14
2032	1,390	1,540	4,080	7,880	64	18	48	—
2034	1,520	1,710	4,700	9,280	68	18	50	—
2035	1,600	1,830	4,700	9,280	70	—	53	—
2036	1,630	1,840	5,050	9,280	72	—	55	—
2038	1,730	2,000	5,670	9,280	76	18	58	14
2040	1,860	2,130	5,670	9,280	80	—	60	—
2042	1,950	2,210	6,270	9,280	84	—	60	—
2044	2,060	2,390	6,880	10,040	88	18	60	—
2045	2,170	2,500	6,880	10,950	90	18	60	—
2046	2,210	2,550	8,170	10,960	92	18	60	14
2048	2,490	2,830	8,890	12,820	96	18	62	—
2050	2,590	2,960	8,970	13,200	100	20	62	—
2052	2,670	3,070	—	—	104	—	—	—
2054	2,860	3,310	—	—	108	—	—	—
2055	2,890	3,320	—	—	110	20	65	14
2056	2,970	3,630	—	—	112	—	—	—
2058	3,190	3,930	—	—	116	—	—	—
2060	3,230	3,940	—	—	120	—	68	—
2062	3,500	3,990	—	—	124	—	68	—
2064	3,780	4,200	—	—	128	20	70	14
2065	3,850	4,240	—	—	130	—	75	—
2066	3,910	4,600	—	—	132	—	75	—
2068	3,960	4,740	—	—	136	—	75	—
2070	3,990	4,800	—	—	140	—	80	—
2072	4,430	5,350	—	—	144	20	80	14
2075	4,680	5,410	—	—	150	—	85	—
2076	4,680	5,870	—	—	152	—	85	—
2080	4,680	5,960	—	—	160	—	90	—
2084	5,080	6,660	—	—	168	—	95	—
2085	5,820	6,690	—	—	170	20	95	14
2088	5,830	7,040	—	—	176	—	100	—
2090	6,450	7,060	—	—	180	—	100	—
2095	7,450	7,620	—	—	190	20	100	—
20100	6,890	8,750	—	—	200	22	110	14
20120	9,320	12,950	—	—	240	22	130	—

●外径はP.C.D+4

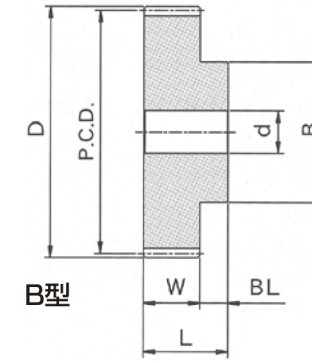
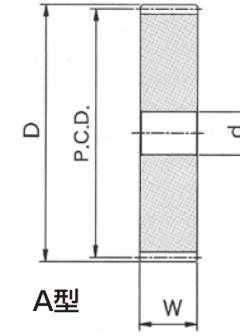

◆品番表示

SS B 30 20

材質 ———— ピッチ ———— 歯数
 SS:S45C 形状
 SN:キャストナイロン A:ベタ
 SU:SUS303 B:片ボス
 SF:FC200

SNA・SNB：キャストナイロン

●MP2.5

歯幅25

品番	価格				寸法			
	S45C		SUS303		P.C.D.	d _{H7}	B	BL
	SSA	SSB	SUA	SUB				
2512	1,010	840	4,060	3,510	30	—	23	—
2513	—	950	—	—	32.5	—	25	—
2514	1,100	950	4,660	3,510	35	12	26	16
2515	1,100	980	4,660	3,510	37.5	—	30	—
2516	1,100	1,060	4,790	3,760	40	—	32	—
2517	1,120	1,120	4,860	4,520	42.5	—	34	—
2518	1,120	1,230	4,860	4,830	45	12	36	—
2519	1,120	1,300	4,940	5,120	47.5	14	40	—
2520	1,130	1,440	5,010	5,600	50	14	42	16
2521	1,330	1,500	5,290	5,670	52.5	14	44	—
2522	1,400	1,640	5,530	6,380	55	14	45	—
2523	1,410	1,710	5,780	6,580	57.5	14	47	—
2524	1,410	1,780	6,020	7,210	60	18	50	—
2525	1,440	1,820	6,140	7,240	62.5	18	50	16
2526	1,640	1,930	6,520	7,820	65	18	52	—
2527	1,710	2,020	6,560	7,830	67.5	18	54	—
2528	1,710	2,150	6,560	9,000	70	18	56	—
2529	1,850	2,210	7,050	9,350	72.5	18	58	—
2530	1,850	2,340	7,100	10,010	75	20	60	16
2532	2,000	2,610	7,180	—	80	20	70	—
2534	2,200	2,830	7,600	—	85	20	70	—
2535	2,230	2,860	7,700	—	87.5	—	70	—
2536	2,340	2,990	8,580	—	90	—	70	—
2538	2,640	3,400	10,220	—	95	20	70	16
2540	2,710	3,520	10,450	—	100	—	75	—
2542	3,150	3,780	11,550	—	105	—	75	—
2544	3,180	3,830						

●MP4.0

歯幅40

品番	価格		寸法				
	SSA	SSB	ピッチ円径 P.C.D	外径 D	穴径 d _{h7}	ボス径 B	ボス長さ BL
4012	1,690	1,850	48	56	18	36	21
4013	—	2,180	52	60	18	40	
4014	1,970	2,210	56	64	18	44	
4015	2,120	2,290	60	68	18	48	
4016	2,260	2,530	64	72	20	52	
4017	2,400	2,780	68	76	20	56	
4018	2,520	3,050	72	80	20	60	
4019	2,670	3,280	76	84	20	63	
4020	3,030	3,560	80	88	22	66	
4021	3,040	3,770	84	92	22	70	
4022	3,280	4,040	88	96	22	72	
4023	3,700	4,630	92	100	22	75	
4024	3,880	4,650	96	104	22	78	
4025	3,930	5,290	100	108	25	84	
4026	4,310	5,380	104	112	25	87	
4027	4,380	5,460	108	116	25	90	
4028	4,740	6,080	112	120		95	
4029	4,860	6,300	116	124		95	
4030	4,860	6,680	120	128	25	100	
4032	5,380	6,780	128	136		100	
4034	6,410	7,260	136	144		100	
4035	6,730	8,160	140	148		100	
4036	6,830	8,220	144	152		100	
4038	8,140	9,260	152	160	28	100	
4040	8,150	10,200	160	168		100	
4042	8,980	10,350	168	176		100	
4044	9,910	11,410	176	184		100	
4045	10,090	12,570	180	188		100	
4046	11,330	12,740	184	192	28	100	
4048	11,410	14,330	192	200		110	
4050	12,340	14,660	200	208		110	
4052	14,420	15,750	208	216	28	110	
4054	14,520	17,130	216	224	28	110	
4055	14,560	18,600	220	228	28	120	
4056	15,610	19,120	224	232	30	120	
4058	17,040	20,300	232	240	30	120	
4060	17,560	21,140	240	248		130	
4062	21,540	22,530	248	256		130	
4064	22,360	24,320	256	264	30	140	
4065	23,030	26,150	260	268		140	
4066	24,810	27,830	264	272		140	
4068	25,770	28,260	272	280		150	
4070	27,590	28,910	280	288	30	150	
4072	30,490	36,080	288	296		150	
4075	32,080	36,080	300	308		150	
4080	38,150	36,080	320	328	30	150	
4085	59,050	76,710	340	348	32	21	

●MP5.0

歯幅50

品番	価格		寸法				
	SSA	SSB	ピッチ円径 P.C.D	外径 D	穴径 d _{h7}	ボス径 B	ボス長さ BL
5012	2,570	3,140	60	70	20	45	24
5013	—	3,630	65	75	20	50	
5014	3,180	3,740	70	80	22	55	
5015	3,490	4,040	75	85	22	60	
5016	3,770	4,410	80	90	25	65	
5017	4,400	4,680	85	95	25	70	
5018	4,460	5,420	90	100	25	75	
5019	4,710	5,570	95	105	25	78	
5020	5,060	6,260	100	110	25	82	
5021	5,210	6,390	105	115	28	90	
5022	5,590	7,220	110	120	28	95	
5023	6,010	7,230	115	125		100	
5024	6,610	8,020	120	130		100	
5025	6,730	8,120	125	135	28	105	
5026	7,260	9,080	130	140		110	
5027	7,450	9,270	135	145		110	
5028	8,290	10,480	140	150		110	
5029	8,720	10,580	145	155		110	
5030	9,240	11,690	150	160	30	120	
5032	10,410	12,630	160	170		120	
5034	11,310	14,210	170	180		120	
5035	11,750	14,290	175	185		120	
5036	12,750	15,550	180	190		120	
5038	14,040	17,680	190	200	30	120	
5040	15,200	19,010	200	210		120	
5042	17,400	20,670	210	220		120	
5044	18,040	22,700	220	230	30	120	
5045	18,080	22,890	225	235	35	130	
5046	20,550	24,600	230	240	35	130	
5048	21,210	27,250	240	250	35	130	
5050	22,700	28,360	250	260	35	140	
5052	32,190	31,610	260	270		140	
5054	35,820	33,970	270	280	35	140	
5055	37,390	34,160	275	285		140	
5058	38,640	39,690	290	300		150	
5060	40,790	41,570	300	310		150	
5062	47,800	72,480	310	320	35	180	
5064	51,670	75,380	320	330		180	
5065	53,240	85,400	325	335		180	

●MP6.0

歯幅60

品番	価格		寸法				
	SSA	SSB	ピッチ円径 P.C.D	外径 D	穴径 d _{h7}	ボス径 B	ボス長さ BL
6012	4,830	4,900	72	84	25	54	28
6013	—	5,740	78	90	25	60	
6014	5,200	5,740	84	96	25	66	
6015	5,200	6,570	90	102	25	72	
6016	6,460	7,410	96	108	28	78	
6017	6,460	7,520	102	114	28	84	
6018	6,670	8,450	108	120	28	90	
6019	6,890	8,620	114	126	28	96	
6020	7,580	9,650	120	132	28	100	
6021	8,540	10,810	126	138	30	105	
6022	8,670	10,970	132	144	30	110	
6023	9,650	12,280	138	150	30	115	
6024	9,750	12,510	144	156	30	120	
6025	10,770	13,710	150	162	30	120	
6026	12,580	15,030	156	168	32	120	
6027	12,580	15,240	162	174	32	130	
6028	13,120	16,960	168	180		130	
6029	13,940	20,170	174	186		130	
6030	14,400	20,350	180	192	32	130	
6032	16,310	21,160	192	204		130	
6034	20,690	22,980	204	216		130	
6035	20,690	26,070	210	222	32	130	
6036	21,120	27,720	216	228	32	130	
6038	25,170	29,370	228	240	32	130	
6040	26,510	33,700	240	252	35	140	
6042	32,430	35,560	252	264	35	140	
6044	32,430	39,730	264	276		140	
6045	33,150	40,220	270	282		140	
6046	41,230	42,560	276	288	35	140	
6048	41,430	46,150	288	300		150	
6050	44,350	48,540	300	312		150	

●MP8.0

歯幅80

品番	価格		寸法				
	SSA	SSB	ピッチ円径 P.C.D	外径 D	穴径 d _{h7}	ボス径 B	ボス長さ BL
8012	10,550	9,720	96	112	30	72	32
8013	—	11,500	104	120	30	80	
8014	13,430	12,530	112	128	30	88	
8015	13,550	12,830	120	136	30	96	
8016	14,880	14,330	128	144	32	104	
8017	15,970	16,090	136	152	32	112	
8018	15,970	17,990	144	160	35	120	
8019	15,970	19,830	152	168	35	120	
8020	15,970	20,280	160	176	35	120	
8021	17,300	22,180	168	184	38	130	
8022	24,080	24,210	176	192	38	130	
8023	27,230	27,180	184	200	38	130	
8024	29,890	29,680	192	208	38	130	
8025	30,250	30,140	200	216	38	140	
8026	32,070	33,020	208	224	40	140	
8027	33,640	35,840	216	232	40	140	
8028	33,640	38,460	224	240	40	140	
8029	36,120	43,560	232	248	40	140	
8030	36,740	43,560	240	256	42	150	
8032	—	73,080	256	272	42	150	
8034	—	91,230	272	288	42	150	
8035	—	91,230	280	296	42	150	
8036	—	97,280	288	304	42	150	
8038	—	113,740	304	320	42	150	
8040	—	136,730	320	336	45	150	

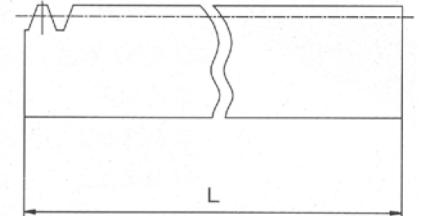
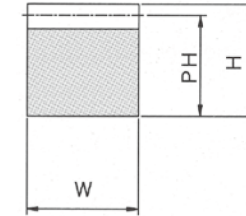
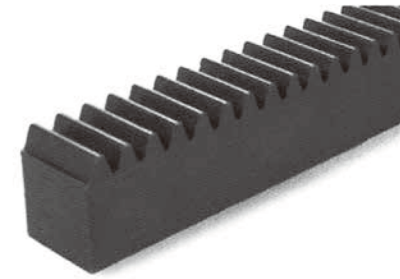

●引抜材ラックギヤ

LR (端面加工無し)・LRS (両端面加工)

●S45C 黒染め

MP	加工無し			両端面加工			有効歯数	歯幅 W	高さ H
	品番	価格	全長 (L)	品番	価格	全長 (L)			
1	LR103	1,600	300	LRS103	2,320	298.45	95	10	12
	LR105	2,600	500	LRS105	3,580	499.51	159	10	12
	LR1010	4,820	1000	LRS1010	6,840	999.03	318	10	12
	LR1015	7,020	1500	LRS1015	8,310	1498.54	477	10	12
1.5	LR153	1,760	300	LRS153	2,540	296.88	63	15	20
	LR155	3,060	500	LRS155	3,920	499.51	106	15	20
	LR1510	6,040	1000	LRS1510	7,740	999.03	212	15	20
	LR1515	8,940	1500	LRS1515	9,900	1498.54	318	15	20
2	LR203	2,400	300	LRS203	3,010	295.3	47	20	25
	LR205	3,890	500	LRS205	4,550	496.37	79	20	25
	LR2010	7,650	1000	LRS2010	8,280	999.02	159	20	25
	LR2015	11,440	1500	LRS2015	12,600	1495.4	238	20	25
2.5	LR253	3,130	300	LRS253	3,740	298.45	38	25	30
	LR255	4,910	500	LRS255	5,620	494.8	63	25	30
	LR2510	10,140	1000	LRS2510	10,710	997.45	127	25	30
	LR2515	15,400	1500	LRS2515	15,750	1492.25	190	25	30
3	LR303	4,080	300	LRS303	4,630				

●引抜材正角ラックギヤ
LQ (S45C)・LRU (SUS304)

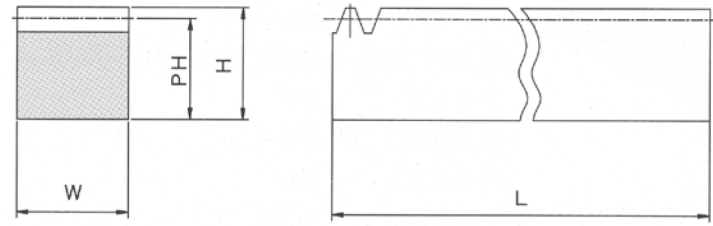

MP	S45C			SUS304			有効歯数	歯幅 W	高さ H
	品番	価格	全長 (L)	品番	価格	全長 (L)			
1	LQ103	1,170	300	LRU103	4,320	300	95	10	10
	LQ105	1,820	500	LRU105	7,800	500	159	10	10
	LQ1010	3,720	1000	—	—	—	318	10	10
	LQ1015	5,510	1500	—	—	—	477	10	10
1.5	LQ153	1,630	300	LRU153	6,030	300	63	15	15
	LQ155	2,550	500	LRU155	9,540	500	106	15	15
	LQ1510	5,140	1000	LRU1510	18,900	1000	212	15	15
	LQ1515	7,610	1500	—	—	—	318	15	15
2	LQ203	2,160	300	LRU203	8,000	300	47	20	20
	LQ205	3,390	500	LRU205	—	—	79	20	20
	LQ2010	6,530	1000	LRU2010	—	—	159	20	20
	LQ2015	9,880	1500	—	—	—	238	20	20
2.5	LQ253	2,930	300	LRU253	—	—	38	25	25
	LQ255	4,580	500	LRU255	17,910	500	63	25	25
	LQ2510	8,860	1000	LRU2510	35,000	1000	127	25	25
	LQ2515	13,750	1500	—	—	—	190	25	25
3	LQ303	3,650	300	—	—	—	31	30	30
	LQ305	5,870	500	LRU305	22,500	500	53	30	30
	LQ3010	11,330	1000	LRU3010	44,910	1000	106	30	30
	LQ3015	17,560	1500	—	—	—	159	30	30
4	LQ403	6,620	300	—	—	—	23	40	40
	LQ405	8,860	500	—	—	—	39	40	40
	LQ4010	17,330	1000	—	—	—	79	40	40
	LQ4015	26,690	1500	—	—	—	119	40	40

生産中止

●磨き材丸ラックギヤ
LOR (S45C)・LOU (SUS304)

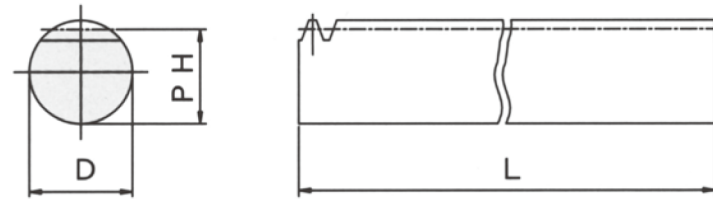

MP	S45C			SUS304			有効歯数	外径 D
	品番	価格	全長 (L)	品番	価格	全長 (L)		
1	LOR103	2,880	300	—	—	—	95	10
	LOR105	4,860	500	LOU105	9,420	500	159	10
	LOR1010	9,210	1000	—	—	—	318	10
1.5	LOR153	4,020	300	—	—	—	63	15
	LOR155	5,110	500	LOU155	11,400	500	106	15
	LOR1510	12,760	1000	—	—	—	212	15
	LOR203	4,800	300	—	—	—	47	20
2	LOR205	6,210	500	—	—	—	79	20
	LOR2010	11,900	1000	LOU2010	6,000	1000	159	20
	LOR253	6,360	300	—	—	—	38	25
2.5	LOR255	8,010	500	—	—	—	63	25
	LOR2510	14,700	1000	LOU2510	32,900	1000	127	25
	LOR303	7,070	300	—	—	—	31	30
3	LOR305	9,720	500	—	—	—	53	30
	LOR3010	17,730	1000	LOU3010	41,580	1000	106	30
	LOR405	13,410	500	—	—	—	39	40
4	LOR4010	25,200	1000	—	—	—	79	40
	LOR5010	35,100	1500	—	—	—	63	50

生産中止

●IS (R:右ネジレ・L:左ネジレ)

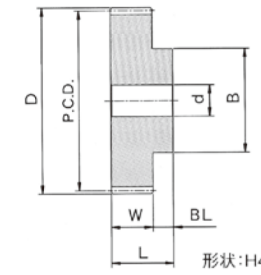

- ネジレ角45°
- 黒染め処理
- 切削仕上

●材質: S45C ●RとR又はLとLの組合せでご使用下さい。

モジュール	MP	品番	価格	品番	価格	主要寸法							
						Z	P.C.D	D	W	B	BL	L	d _{H7}
1.0	IS1012R	IS1012L	530	IS1012L	530	12	16.97	18.97	10	14	10	20	6
		IS1020R	840	IS1020L	840	20	28.28	30.28					6
		IS1024R	1,000	IS1024L	1,000	24	33.94	35.94					8
		IS1036R	1,620	IS1036L	1,620	36	50.91	52.91					10
1.5	IS1510R	IS1510L	780	IS1510L	780	10	21.21	24.21	15	16	12	27	8
		IS1512R	910	IS1512L	910	12	25.46	28.46					8
		IS1513R	910	IS1513L	910	13	27.58	30.58					10
		IS1515R	1,050	IS1515L	1,050	15	31.82	34.82					10
		IS1520R	1,320	IS1520L	1,320	20	42.43	45.43					12
		IS1524R	1,650	IS1524L	1,650	24	50.91	53.91					12
		IS1526R	1,930	IS1526L	1,930	26	55.15	58.15					12
		IS1530R	2,150	IS1530L	2,150	30	63.64	66.64					12
2.0	IS2010R	IS2010L	1,010	IS2010L	1,010	10	28.28	32.28	18	22	14	32	12
		IS2012R	1,180	IS2012L	1,180	12	33.94	37.94					12
		IS2013R	1,320	IS2013L	1,320	13	36.77	40.77					12
		IS2015R	1,420	IS2015L	1,420	15	42.43	46.43					12
		IS2020R	1,980	IS2020L	1,980	20	56.57	60.57					15
		IS2024R	2,330	IS2024L	2,330	24	67.88	71.88					16
		IS2026R	2,630	IS2026L	2,630	26	73.54	77.54					20
		IS2030R	3,230	IS2030L	3,230	30	84.85	88.85					20
2.5	IS2510R	IS2510L	1,520	IS2510L	1,520	10	35.36	40.36	22	28	16	38	12
		IS2512R	1,550	IS2512L	1,550	12	42.43	47.43					14
		IS2513R	1,780	IS2513L	1,780	13	45.96	50.96					15
		IS2515R	1,830	IS2515L	1,830	15	53.03	58.03					15
		IS2520R	2,460	IS2520L	2,460	20	70.71	75.71					20
		IS2524R	3,140	IS2524L	3,140	24	84.85	89.85					20
		IS2526R	3,800	IS2526L	3,800	26	91.92	96.92					20
		IS2530R	5,180	IS2530L	5,180	30	106.07	111.07					20
3.0	IS3010R	IS3010L	1,760	IS3010L	1,760	10	42.43	48.43	26	34	18	44	15
		IS3012R	2,020	IS3012L	2,020	12	50.91	56.91					16
		IS3013R	2,090	IS3013L	2,090	13	55.15	61.15					20
		IS3015R	2,630	IS3015L	2,630	15	63.64	69.64					20
		IS3020R	3,210	IS3020L	3,210	20	84.85	90.85					20
		IS3024R	4,540	IS3024L	4,540	24	101.82	107.82					20
		IS3026R	5,120	IS3026L	5,120	26	110.31	116.31					20
		IS3030R	7,280	IS3030L	7,280	30	127.28	133.28					20
4.0	IS4012R	IS4012L	3,390	IS4012L	3,390	12	67.88	75.88	32	50	21	53	18
		IS4020R	6,840	IS4020L	6,840	20	113.14	121.14					20
		IS4024R	9,410	IS4024L	9,410	24	135.76	143.76					20
		IS4036R	21,420	IS4036L	21,420	36	203.65	211.65					25

●BSM (S45C)
BUM (SUS303)

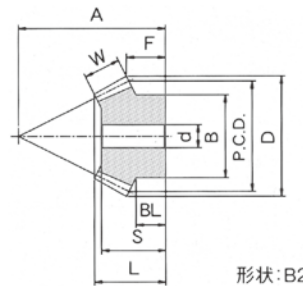

形状:B2

●歯数:20

BSM (S45C)		BUM (SU303)		主要寸法										
品番	価格(1ヶ)	品番	価格(1ヶ)	MP	P.C.D	D	W	A	F	B	BL	L	S	d _{H7}
BSM 1020	810	BUM 1020	1,630	1.0	20	21.4	6	20	10.7	16	8	14.65	13	6
BSM 1220	940	BUM 1220	2,310	1.25	25	26.7	6	23	11.3	22	9	15.24	13	8
BSM 1520	1,010	BUM 1520	2,520	1.5	30	32.1	8	30	16.1	26	13	21.32	19	10
BSM 2020	1,270	BUM 2020	3,450	2.0	40	42.8	12	35	16.4	34	12	24.29	21	12
BSM 2520	1,650	BUM 2520	5,230	2.5	50	53.5	14	50	26.8	40	20	35.97	32	15
BSM 3020	2,150	BUM 3020	7,540	3.0	60	64.2	15	60	32.1	46	23	41.98	37	15
BSM 3520	2,780	BUM 3520	11,610	3.5	70	74.9	18	65	32.5	60	25	44.32	40	20
BSM 4020	3,630	BUM 4020	15,610	4.0	80	85.7	18	72	34.8	65	24.5	46.66	40	20
BSM 5020	5,560	BUM 5020	27,230	5.0	100	107.1	22	88	41.5	80	28	55.99	48	25
BSM 6020	8,450	BUM 6020	—	6.0	120	128.5	28	102	46.2	95	29.5	64.64	55	30
BSM 7020	15,310	BUM 7020	—	7.0	140	149.9	33	120	55.1	115	37.6	76.75	65	35
BSM 8020	16,230	BUM 8020	—	8.0	160	171.3	36	135	60.7	130	40	84.31	70	40

●歯数:25

BSM (S45C)		BUM (SU303)		主要寸法										
品番	価格(1ヶ)	品番	価格(1ヶ)	MP	P.C.D	D	W	A	F	B	BL	L	S	d _{H7}
BSM 1025	980	BUM 1025	1,980	1.0	25	26.4	6	23	11.2	20	8	15.21	14	6
BSM 1225	1,160	BUM 1225	2,900	1.25	31.25	33	7	28	13.2	25	9.2	17.95	16	8
BSM 1525	1,380	BUM 1525	2,990	1.5	37.5	39.6	8	34	16.3	30	11.5	21.65	19	10
BSM 2025	1,710	BUM 2025	4,500	2.0	50	52.8	12	43	19.4	40	13	27.42	24	12
BSM 2525	2,090	BUM 2525	6,990	2.5	62.5	66	15	55	25.5	50	17.5	35.53	32	15
BSM 3025	2,700	BUM 3025	10,020	3.0	75	79.2	18	65	29.6	60	20	41.63	37	15
BSM 3525	3,690	BUM 3525	16,460	3.5	87.5	92.4	22	70	28.7	70	17.5	43.37	37	18
BSM 4025	5,060	BUM 4025	23,110	4.0	100	105.7	22	85	37.8	80	25	52.51	45	18
BSM 5025	8,750	BUM 5025	35,820	5.0	125	132.1	28	98	39	100	28	57.72	48	25
BSM 6025	12,730	BUM 6025	—	6.0	150	158.5	35	120	49.2	120	35	72.59	60	30
BSM 7025	30,730	BUM 7025	—	7.0	175	184.9	40	140	57.5	130	40	84.14	70	35
BSM 8025	38,720	BUM 8025	—	8.0	200	211.3	45	155	60.7	150	42	90.68	75	40

●歯数:30

BSM (S45C)		BUM (SU303)		主要寸法										
品番	価格(1ヶ)	品番	価格(1ヶ)	MP	P.C.D	D	W	A	F	B	BL	L	S	d _{H7}
BSM 1030	1,160	BUM 1030	4,480	1.0	30	31.4	7	28	13.7	24	10	18.43	16	8
BSM 1230	1,540	BUM 1230	6,700	1.25	37.5	39.3	8	36	18.1	30	13.5	23.49	21	10
BSM 1530	1,650	BUM 1530	7,370	1.5	45	47.1	10	40	18.6	35	12.5	25.3	22	12
BSM 2030	2,170	BUM 2030	10,010	2.0	60	62.8	14	50	21.4	45	16	30.85	28	16
BSM 2530	2,970	BUM 2530	13,550	2.5	75	78.5	18	62	26.3	55	20	38.4	34	18
BSM 3030	4,020	BUM 3030	18,030	3.0	90	94.2	22	75	32.1	65	24	46.94	42	22
BSM 3530	6,220	BUM 3530	27,830	3.5	105	110	22	85	35	90	25	49.82	45	25
BSM 4030	7,210	BUM 4030	32,910	4.0	120	125.7	28	100	42.8	90	32	61.7	56	28
BSM 5030	13,040	BUM 5030	—	5.0	150	157.1	35	125	53.5	120	40	77.12	70	35
BSM 6030	27,350	BUM 6030	—	6.0	180	188.5	45	150	64.2	140	48	94.56	85	40
BSM 7030	66,550	BUM 7030	—	7.0	210	219.9	50	170	70	160	50	103.64	94	45
BSM 8030	67,640	BUM 8030	—	8.0	240	251.3	55	190	75.7	180	55	112.71	102	50

●BSS (歯数20:30)

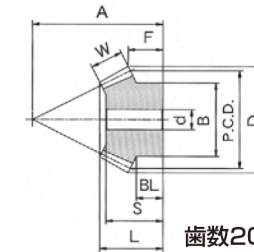

歯数20

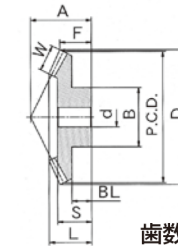

歯数30

●速比1:1.5

材質:S45C

BSM (S45C)		モジュール	P.C.D	D	W	A	F	B	BL	L	S	d _{H7}
品番	価格(1ヶ)	MP										
BSS 1020	1,070	1.0	20	21.6	6	23	8.5	16	6.7	13.35	12	6
BSS 1030	1,520		30	31.1		20	10.8	20	8	13.88	12	8
BSS 1520	1,420	1.5	30	32.5	8	34	12.3	25	9.9	18.73	17	8
BSS 1530	1,890		45	46.7		28	14.2	34	10	18.31	16	10
BSS 2020	1,760	2.0	40	43.3	11	45	16.1	32	12.3	24.91	22	10
BSS 2030	2,370		60	62.2		40	21.6	44	15	27.25	23	10
BSS 2520	2,260	2.5	50	54.1	15	55	18.8	40	14.2	30.90	28	12
BSS 2530	2,870		75	77.8		50	27.0	54	18	34.70	30	15
BSS 3020	3,090	3.0	60	65.0	17	70	26.6	48	21	40.28	37	15
BSS 3030	3,960		90	93.3		55	27.5	66	17	36.13	31	15
BSS 4020	4,760	4.0	80	86.6	20	90	32.2	64	24.7	48.24	43	15
BSS 4030	6,600		120	124.4		75	38.3	88	25	48.49	40	20
BSS 5020	8,360	5.0	100	108.3	30	110	37.8	83	29.3	61.81	56	20
BSS 5030	9,900		150	155.5		90	44.2	105	24	59.42	50	25

●BSA (歯数15:30)

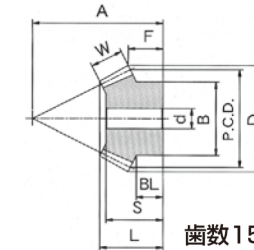

歯数15

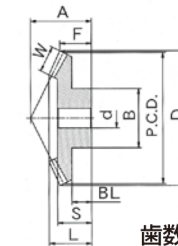

歯数30

●速比1:2

材質:S45C

BSM (S45C)		モジュール	P.C.D	D	W	A	F	B	BL	L	S	d _{H7}
品番	価格(1ヶ)	MP										
BSA 1015	960	1.0	15	16.8	5.5	23.5	9.0	12	7.8	13.72	13	6
BSA 1030	1,540		30	30.9		19.5	12.9	22	8	15.06	13	6
BSA 1515	1,130	1.5	22.5	25.2	8.3	32	10.2	18	8.4	17.37	16	6
BSA 1530	1,890		45	46.3		25	15.1	34	10	18.36	15	8
BSA 2015	1,270	2.0	30	33.6	11	43	13.9	24	11.5	23.44	22	8
BSA 2030	2,310		60	61.8		32	18.8	44	12	23.13	19	10
BSA 2515	1,630	2.5	37.5	42.0	14	54	17.6	30	14.6	29.77	28	10
BSA 2530	2,680		75	77.2		39	22.5	54	14	28.01	24	12
BSA 3015	2,310	3.0	45	50.4	16.7	63	19.3	35	15.5	33.83	31	12
BSA 3030	3,890		90	92.7		44	24.2	66	15	30.76	25	15
BSA 4015	3,340	4.0	60	67.2	22	85	26.8	45	21.1	45.88	42	15
BSA 4030	6,350		120	123.6		57	30.6	85	19	39.25	32	18
BSA 5015	4,750	5.0	75	83.9	27	104	31.2	55	24	54.67	50	15
BSA 5030	8,250		150	154.5		71	38.0	100	24	48.61	40	20

●BSB (歯数20:40)

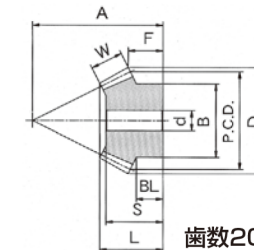

歯数20

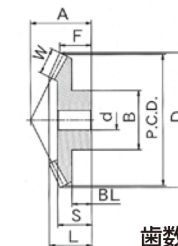

歯数40

●速比1:2

材質:S45C

BSM (S45C)		モジュール	P.C.D	D	W	A	F	B	BL	L	S	d _{H7}
品番	価格(1ヶ)	MP										
BSB 1020	1,050	1.0	20	21.8	5.7	29.6	10.1	16	8.6	15.03	14	6
BSB 1040	1,820		40	40.9		21.8	12.7	30	8	15.01	13	8
BSB 1220	1,330	1.25	25	28	8	36	11.7	22	10.2	18.64	17	8
BSB 1240	2,500		50	50.7		27	15.2	35	10	18.78	16	10
BSB 1520	1,430	1.5	30	32.7	12	46	16.7	25	14.8	27.16	26	8
BSB 1540	2,700		60	61.3		35	21.3	44	15	26.23	23	10
BSB 2020	1,820	2.0	40	43.6	18	62	22.9	32	20	38.63	37	10
BSB 2040	3,140		80	81.8		45	26.8	60	20	34.12	31	12
BSB 2520	2,180	2.5	50	54.5	20	75	26.1	40	22.5	43.61	41	12
BSB 2540	4,350		100	102.2		55	32.2	74	21	40.39	35	15
BSB 3020	3,090	3.0	60	65.4	25	90	31.3	50	27.5	53.20	50	15
BSB 3040	5,710		120	122.7		65	37.7	86	26	47.87	42	15
BSB 4020	4,760	4.0	80	87.2	28	109	30.8	60	24	55.28	50	18
BSB 4040	10,030		160	163.6		74	37					

●BSE (歯数18:36)

●速比1:2

材質:S45C

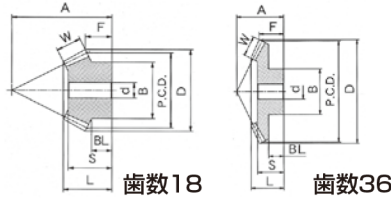

品番	価格	MP	P.C.D	D	W	A	F	B	BL	L	S	d _{H7}
BSE 1518	1,460	1.5	27	29.7	9.8	40.74	14.4	22	12.5	23	21	8
BSE 1536	2,610		54	55.4		26.75	14.6	36	10	18.5	15.5	10
BSE 2018	2,020	2.0	36	39.6	12.6	53.12	18	28	15	29	27	8
BSE 2036	3,510		72	73.8		35.12	19	50	13	24	21	12
BSE 2518	2,220	2.5	45	49.5	16.7	64.29	20.4	36	17	35	32	12
BSE 2536	4,180		90	92.2		42.55	22.3	60	15	29	25	14
BSE 3018	2,840	3.0	54	59.4	20	75.27	22.6	41	18	40	37	12
BSE 3036	5,940		108	110.7		52.32	28	75	19	36	31	16
BSE 4018	4,290	4.0	72	79.2	25.8	99.73	29.5	55	23.5	52	48	18
BSE 4036	7,350		144	147.6		71.56	39.14	100	23	49.5	42	22
BSE 5018	7,280	5.0	90	98.9	31.7	122	34.25	70	26	61.92	58	22
BSE 5036	24,080		180	184.5		86.23	45.7	130	28	58.48	49	28

●BSF (歯数18:45)

●速比1:2.5

材質:S45C

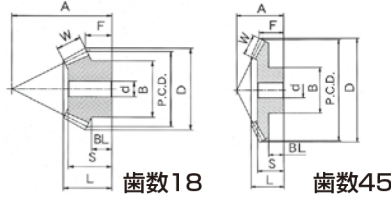

品番	価格	MP	P.C.D	D	W	A	F	B	BL	L	S	d _{H7}
BSF 1018	1,000	1.0	18	19.9	8	32	9.87	14	8.7	17.2	16.5	6
BSF 1045	2,060		45	45.7		24.5	16.43	30	10	19.1	17	8
BSF 1218	1,140	1.25	22.5	24.8	10	40	12.34	19	11.2	21.5	20.5	8
BSF 1245	2,450		56.2	57.1		26	15.91	34	10	19.2	16	10
BSF 1518	1,310	1.5	27	29.8	12	45	11.81	22	10.3	22.8	22	8
BSF 1545	3,050		67.5	68.6		30	17.89	46	11	21.9	19	10
BSF 2018	1,740	2.0	36	39.7	16	60	15.74	30	13.8	30.4	28	10
BSF 2045	4,220		90	91.5		39	22.86	60	14	28.2	24	12
BSF 2518	2,110	2.5	45	49.6	20	72	16.86	36	14.7	34.9	33	12
BSF 2545	5,690		112.5	114.4		50	29.82	80	18	36.5	31	15
BSF 3018	2,770	3.0	54	59.6	22	85	18.62	45	15.7	38.7	36	15
BSF 3045	7,570		135	137.2		60	35.79	95	22	43.1	36	15
BSF 4018	4,140	4.0	72	79.4	30	110	21.49	62	18	48.9	46	18
BSF 4045	13,860		180	183		75	42.71	120	25	52.7	45	20
BSF 5018	6,700	5.0	90	99.3	35	135	24.36	72	18.9	56.32	52	20
BSF 5045	20,900		225	228.7		90	49.64	140	28	61.3	51	22

●BSC (歯数15:45)

●速比1:3

材質:S45C

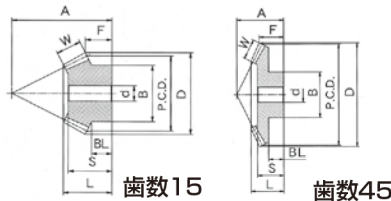

品番	価格	MP	P.C.D	D	W	A	F	B	BL	L	S	d _{H7}
BSC 1015	1,010	1.0	15	16.9	7	32	9.8	12	9	16.37	16	6
BSC 1045	2,010		45	45.6		19.5	13.0	32	8	14.88	12.5	8
BSC 1215	1,060	1.25	18.75	21.1	8	36	8.4	15	7.3	15.82	15	8
BSC 1245	2,390		56.25	57		21	12.3	40	6	14.61	12	10
BSC 1515	1,200	1.5	22.5	25.4	12	47	13.7	18	12.5	24.94	24.5	8
BSC 1545	3,160		67.5	68.5		28.3	18.5	50	12	21.78	18.5	10
BSC 2015	1,440	2.0	30	33.8	14	60.9	16.5	22	14.6	29.62	28	10
BSC 2045	4,160		90	91.3		34.8	21.7	64	13	25.57	21	12
BSC 2515	1,760	2.5	37.5	42.2	19	77.93	22.5	28	20.1	40.24	38	10
BSC 2545	4,840		112.5	114.1		40.64	24.3	80	15	29.54	24.5	15
BSC 3015	2,570	3.0	45	50.7	22	89.36	22.8	34	20	43.39	41	12
BSC 3045	6,800		135	136.9		50.95	31.3	96	20	37.38	31	18
BSC 4015	3,580	4.0	60	67.6	28	115	26.3	45	22.5	52.45	50	15
BSC 4045	12,670		180	182.5		67	40.8	120	27	48.52	40	20
BSC 5015	5,090	5.0	75	84.5	35	141.5	30.6	55	25.7	63.32	60	18
BSC 5045	18,350		225	228.2		80	47.2	140	31	56.91	47	25

●BSD (歯数15:60)

●速比1:4

材質:S45C

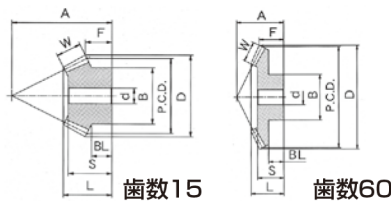

品番	価格	MP	P.C.D	D	W	A	F	B	BL	L	S	d _{H7}
BSD 1015	1,110	1.0	15	16.9	8	38.31	8.6	12	7.9	16.25	16	6
BSD 1060	2,950		60	60.5		22.53	16	42	10	17.69	15	8
BSD 1515	1,360	1.5	22.5	25.4	12	56.06	11.4	18	10.5	22.97	22	8
BSD 1560	4,500		90	90.7		29.29	19.5	64	12	22.03	18	10
BSD 2015	1,610	2.0	30	33.9	16	73.81	14.3	24	13.1	29.69	28	10
BSD 2060	6,480		120	121.0		36.56	23.5	80	14	26.88	22	12
BSD 2515	1,970	2.5	37.5	42.4	20	91.55	17.2	30	15.6	36.41	35	10
BSD 2560	8,790		150	151.2		46.32	30.0	100	18	34.22	28	15
BSD 3015	2,760	3.0	45	50.8	24	108.11	18.8	36	17	41.94	40	12
BSD 3060	12,580		180	181.5		54.59	35.0	120	20	40.07	32	18

●WSウォームギヤ

●S45C 墨染め

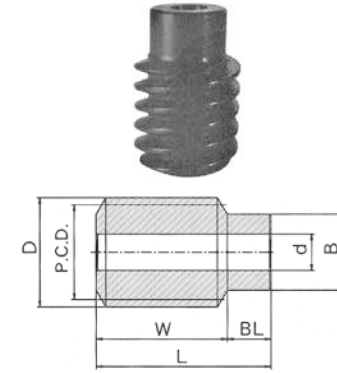

右1条			右2条			M.P	主要寸法						
品番	価格	進み角	品番	価格	進み角		P.C.D	D	W	B	L	d _{H7}	
WS 10S	640	3° 35'	WS 10D	650	7° 08'	1	16	18	20	18	32	6	
WS 15S	990	3° 26'	WS 15D	1,030	6° 51'	1.5	25	28	28	20	40	10	
WS 20S	1,060	3° 42'	WS 20D	1,130	7° 23'	2	31	35	37	25	50	12	
WS 25S	1,850	3° 52'	WS 25D	1,960	7° 43'	2.5	37	42	45	30	63	14	
WS 30S	2,300	3° 54'	WS 30D	2,380	7° 47'	3	44	50	55	35.7	75	16	
WS 40S	5,150	4° 01'	WS 40D	5,310	7° 59'	4	57	65	70	45	95	22	
WS 50S	8,090	4° 24'	WS 50D	8,200	8° 51'	5	65	75	90	52	120	25	
WS 60S	10,560	4° 24'	WS 60D	10,760	8° 45'	6	78	90	110	62	150	30	
WS 80S	20,930	4° 52'	WS 80D	22,630	9° 04'	8	94	110	150	72	200	35	
WS100S	38,480	5° 12'	WS100D	41,260	10° 18'	10	110	130	190	82	250	40	

●HFホイールギヤ

●FC200

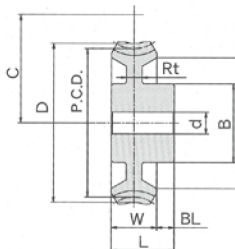
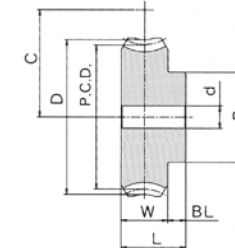

右1条			右2条			M.P	歯数	主要寸法							
品番	価格	減速比	品番	価格	減速比			C	P.C.D	D	W	B	BL	L	d _{H7}
HF 1020S	640	1:20	HF 1020D	640	1:10	1	20	18	20	10	16	10	20	6	
HF 1030S	950	1:30	HF 1030D	950	1:15	1	30	23	30	32	10	20	10	20	6
HF 1040S	1,150	1:40	—	—	—	1	40	28	40	42	10	26	10	20	8
HF 1050S	1,270	1:50	—	—	—	1	50	33	50	52	10	30	10	20	8
HF 1060S	1,310	1:60	—	—	—	1	60	38	60	62	10	30	10	20	10
HF 1520S	990	1:20	HF 1520D	990	1:10	1.5	20	27.5	30	33	12	22	10	22	8
HF 1530S	1,070	1:30	HF 1530D	1,040	1:15	1.5	30	35	45	48	12	30	10	22	10
HF 1540S	1,400	1:40	—	—	—	1.5	40	42.5	60	63	12	30	10	22	12
HF 1550S	1,820	1:50	—	—	—	1.5	50	50	75	78	14	40	10	24	12
HF 1560S	2,140	1:60	—	—	—	1.5	60	57.5	90	93	14	40	10	24	12
HF 2020S	1,170	1:20	HF 2020D	1,170	1:10	2	20	35.5	40	44	22	33	13	35	12
HF 2030S	1,660	1:30	HF 2030D	1,660	1:15	2	30	45.5	60	64	22	40	13	35	12
HF 2040S	2,300	1:40	—	—	—	2	40	55.5	80	84	22	45	13	35	12
HF 2050S	2,740	1:50	—	—	—	2	50	65.5	100	104	22	48	13	35	12
HF 2060S	3,310	1:60	—	—	—	2	60	75.5	120	124	22	50	13	35	12
HF 2520S	1,430	1:20	HF 2520D	1,430	1:10	2.5	20	43.5	50	55	22	35	14	36	12
HF 2530S	2,020	1:30	HF 2530D	2,020	1:15	2.5	30	56	75	80	22	40	14	36	12
HF 2540S	2,750	1:40	—	—	—	2.5	40	68.5	100	105	22	45	14	36	15
HF 2550S	3,420	1:50	—	—	—	2.5	50	81	125	130	22	50	14	36	15
HF 2560S	4,270	1:60	—	—	—	2.58	60	93.5	150	155	22	55	14	36	15
HF 3020S	2,080	1:20	HF 3020D	2,080	1:10	3	20	52	60	66	28	50	15		

●PBS (スパイラルマイタ)
(R:右ネジレ・L:左ネジレ)

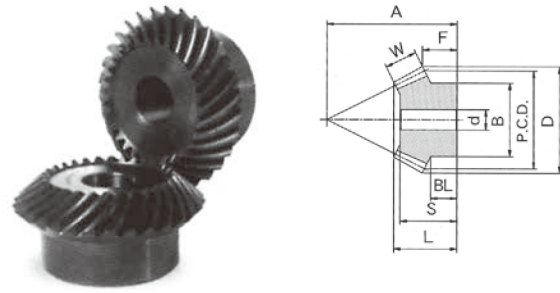

●速比1:1 ●材質:S45C 黒染め

歯数	品番		価格 (1ヶ)	モジュール MP	ピッチ 円直径 P.C.D.	外径 D	歯幅 W	組立 距離 A	歯先 距離 F	ボス 径 B	ボス 長さ BL	全長 L	穴 長さ S	穴径 d _{H7}
	右ネジレ	左ネジレ												
20	PBS1020R	PBS1020L	780	1.0	20	21.2	4.5	20	10.6	16	8	13.48	12	6
	PBS1220R	PBS1220L	920	1.25	25	26.5	6	23	11.3	22	9	15.23	13	8
	PBS1520R	PBS1520L	1,060	1.5	30	32	7	27	13	26	10	17.47	15.5	8
	PBS2020R	PBS2020L	1,410	2.0	40	42.3	9	35	16.1	34	12	22.15	19	10
	PBS2220R	PBS2220L	1,740	2.25	45	47.73	10	40	18.86	36	13	25.37	22	10
	PBS2520R	PBS2520L	1,740	2.5	50	52.9	11	44	20.5	40	14	27.78	24	12
PBS3020R	PBS3020L	2,410	3.0	60	63.7	15	60	31.9	46	23	41.56	37	15	
25	PBS1025R	PBS1025L	1,280	1.0	25	26.1	6	23	11	20	8	15.01	14	6
	PBS1225R	PBS1225L	1,410	1.25	31.2	32.8	7	28	13.1	25	9.3	17.76	16	8
	PBS1525R	PBS1525L	1,410	1.5	37.5	39.2	9	34	16.1	30	11.5	21.97	19	10
	PBS2025R	PBS2025L	1,900	2.0	50	52.4	12	43	19.2	40	13	27.2	24	12
	PBS2225R	PBS2225L	2,180	2.25	56.25	59.04	12	48	21.27	45	14.25	29.16	26	12
	PBS2525R	PBS2525L	2,450	2.5	62.5	65.5	15	55	25.3	50	17.5	35.36	32	15
PBS3025R	PBS3025L	3,330	3.0	75	78.7	18	65	29.4	60	20	41.23	37	15	
30	PBS1030R	PBS1030L	1,570	1.0	30	31.16	7	28	13.58	24	10	18.24	16	8
	PBS1230R	PBS1230L	1,570	1.25	37.5	39	8	36	18	30	13.5	23.38	21	10
	PBS1530R	PBS1530L	2,270	1.5	45	46.82	10	40	18.41	35	12.5	25.11	22	12
	PBS2030R	PBS2030L	3,520	2.0	60	62.45	14	50	21.23	45	16	30.59	28	16
	PBS2230R	PBS2230L	4,550	2.25	67.5	70.17	15	56	23.59	50	18	33.70	31	18
	PBS2530R	PBS2530L	4,140	2.5	75	78.58	17	62	26.03	55	20	37.39	35	20
PBS3030R	PBS3030L	4,280	3.0	90	93.62	22	75	31.81	65	24	46.59	42	22	

●スパイラルベベルギヤ



●PBSS 歯数20:30 速比1:1.5 材質:S45C黒染め

品番	価格	モジュール MP	ピッチ 円直径 P.C.D.	外径 D	歯幅 W	組立 距離 A	歯先 距離 F	ボス 径 B	ボス 長さ BL	全長 L	穴 長さ S	穴径 d _{H7}
PBSS1030R	2,240	1.0	30	30.70	6	22	12.53	22	9	15.65	14	8
PBSS1520L	2,160	1.5	30	32.60	8	35	13.37	26	11.2	19.76	18	8
PBSS1530R	3,280	1.5	45	46.01	8	30	15.76	34	11	19.95	18	10
PBSS2020L	2,640	2.0	40	43.55	11	45	16.18	35	13.3	24.91	23	10
PBSS2030R	4,000	2.0	60	61.41	11	40	21.05	44	15	26.74	23	12
PBSS2520L	3,940	2.5	50	54.45	15	55	18.98	43	15.2	30.87	28	12
PBSS2530R	6,040	2.5	75	76.76	15	50	26.32	50	18	34.06	30	15
PBSS3020L	5,020	3.0	60	65.35	17	65	21.78	52	17.3	32.25	32	15
PBSS3030R	7,280	3.0	90	92.12	17	60	31.59	65	22	40.35	36	18

●PBSB 歯数20:40 速比1:2 材質:S45C黒染め

品番	価格	モジュール MP	ピッチ 円直径 P.C.D.	外径 D	歯幅 W	組立 距離 A	歯先 距離 F	ボス 径 B	ボス 長さ BL	全長 L	穴 長さ S	穴径 d _{H7}
PBSB1040R	1,760	1.0	40	40.51	7	22	12.51	30	8	14.99	12	8
PBSB1520L	1,650	1.5	30	33.06	10	46	16.77	25	14.75	25.44	24	8
PBSB1540R	3,280	1.5	60	60.74	10	35	20.75	40	15	24.93	22	10
PBSB2020L	2,370	2.0	40	44.11	15	60	21.03	32	18	34.01	32	10
PBSB2040R	4,270	2.0	80	81.01	15	45	26.01	50	18	32.24	27	12
PBSB2520L	3,940	2.5	50	55.19	20	75	26.03	40	22.5	43.58	40	12
PBSB2540R	7,490	2.5	100	101.28	20	55	31.28	65	20	39.54	34	15

●PBSE (歯数18:36)・PBSC (歯数15:45) はお見積り下さい。

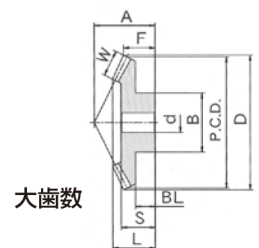
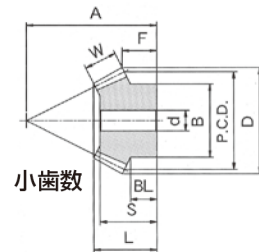

小歯数
大歯数

●CPスパークギヤ

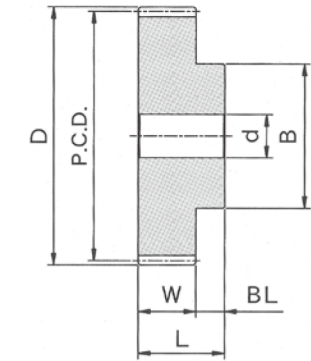

●CPラックギヤ

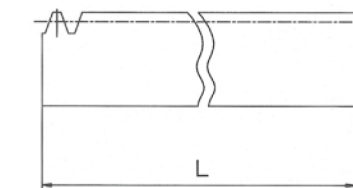
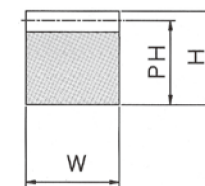
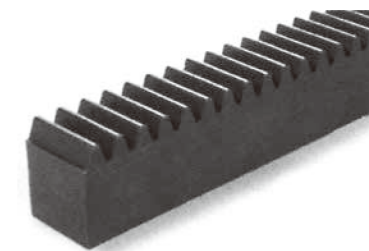

●SSCPB ●S45C 黒染め

サーキュラ ピッチCP	品番	価格	歯数	P.C.D.	D	W	d _{H7}	B	BL	L
2.5	SSCPB 2520	750	20	15.91	17.5			10		
	SSCPB 2525	830	25	19.89	21.48			15		
	SSCPB 2530	930	30	23.87	25.46	8	6	20	8	16
	SSCPB 2535	1,140	35	27.85	29.44			24		
	SSCPB 2540	1,150	40	31.83	33.42			28		
5	SSCPB 5020	1,100	20	31.83	35.01			10		
	SSCPB 5025	1,410	25	39.78	42.97			10		
	SSCPB 5030	1,760	30	47.74	50.92	15	14	40	12	27
	SSCPB 5035	2,160	35	55.7	58.88			16		
	SSCPB 5040	2,420	40	63.66	66.84			16		
10	SSCPB10020	2,530	20	63.66	70.03			18		
	SSCPB10025	3,300	25	79.57	85.94			18		
	SSCPB10030	5,170	30	95.49	101.86	30	20	75	18	48
	SSCPB10035	6,930	35	111.4	117.77			22		
	SSCPB10040	6,930	40	127.32	133.69			22		
15	SSCPB15020	7,040	20	95.49	105.04			25		
	SSCPB15025	9,340	25	119.36	128.91			28		
	SSCPB15030	12,090	30	143.23	152.78	50	30	120	24	74
	SSCPB15035	24,200	35	167.11	176.66			30		
	SSCPB15040	32,550	40	190.98	200.53			30		
20	SSCPB20020	11,790	20	127.32	140.05			28		
	SSCPB20025	15,950	25	159.15	171.88			30		
	SSCPB20030	20,900	30	190.98	203.71	60	32	130	28	88
	SSCPB20035	45,740	35	222.81	235.54			32		
	SSCPB20040	68,120	40	254.64	267.38			35		

●LRCP 端面加工なし ●S45C 引抜材 黒染め

CP	品番	価格	L	Z	W	H	PH
2.5	LRCP 2510	5,060	1000	400			
	LRCP 2515	7,370	1500	600	10	12	11.2
	LRCP 2520	10,210	2000	800			
5	LRCP 5010	6,990	1000	200			
	LRCP 5015	10,670	1500	300	15	20	18.41
	LRCP 5020	14,960	2000	400			
10	LRCP10010	14,850	1000	100			
	LRCP10015	22,660	1500	150	30	35	31.82
	LRCP10020	32,120	2000	200			
15	LRCP15010	33,220	1000	66			
	LRCP15015	49,280			50	50	45.23
	LRCP15020	67,320					
20	LRCP20010	48,070			60	60	53.63
	LRCP20015	73,480					

生産中止

●LRCPs 両端加工 ●S45C 引抜材 黒染め

CP	品番	価格	L	Z	W	H	PH
5	LRCPs 5010	7,090	1000	200			
	LRCPs 5015	10,400	1500	300	15	20	18.41
10	LRCPs10010	14,400	1000	100			
	LRCPs10015	23,650	1500	150	30	35	31.82
15	LRCPs15010	32,130	990	66			
	LRCPs15015	49,300	1500	100	50	50	45.23